

H7~H20

series

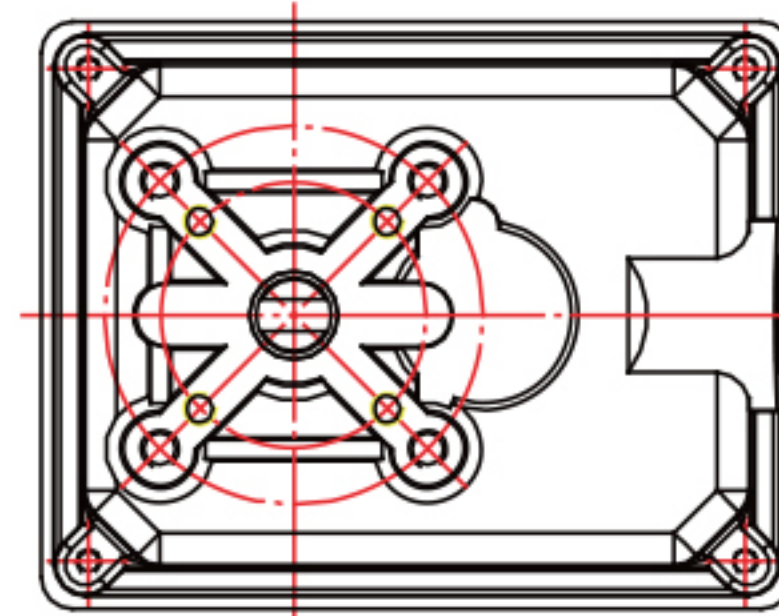

H7~H20- B

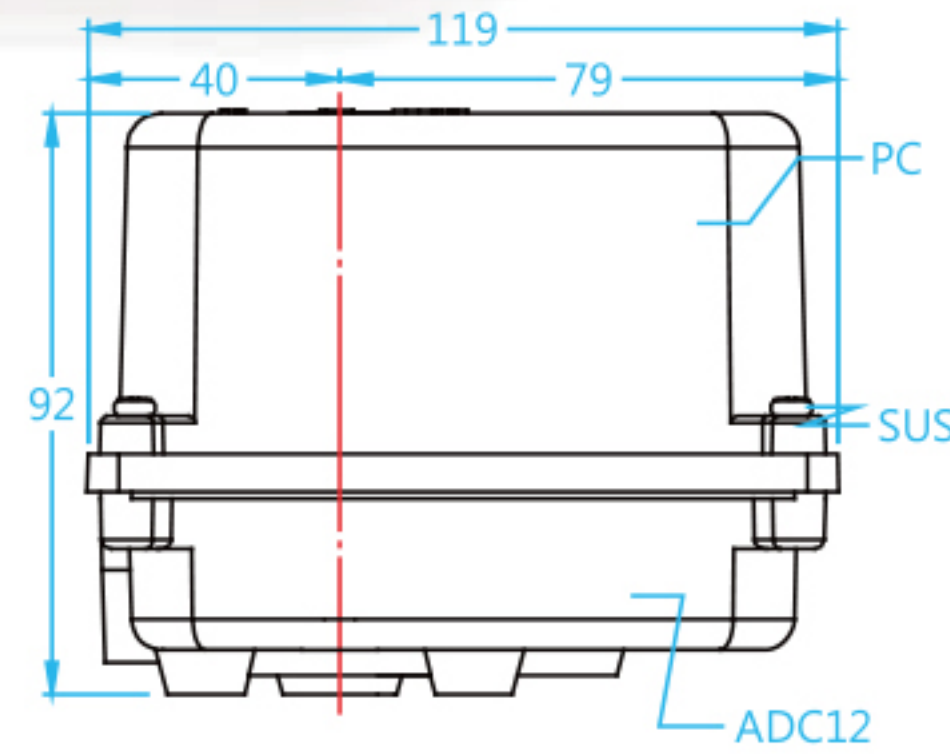
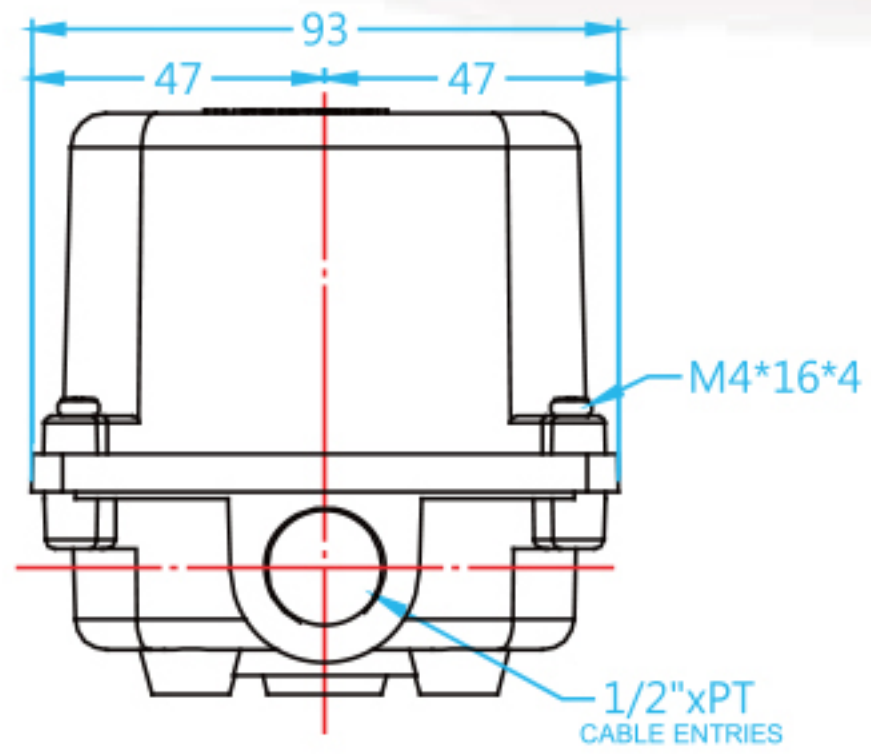
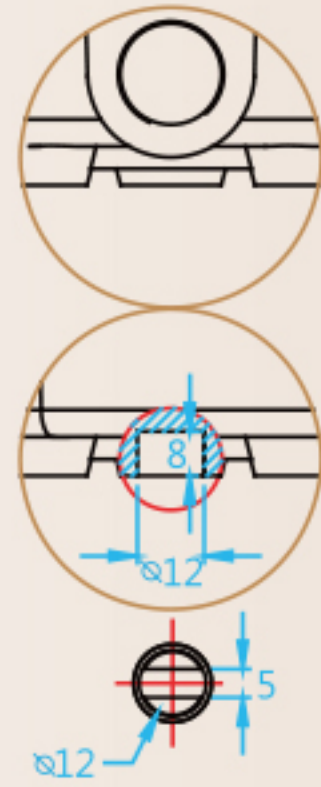

H7~H20- N

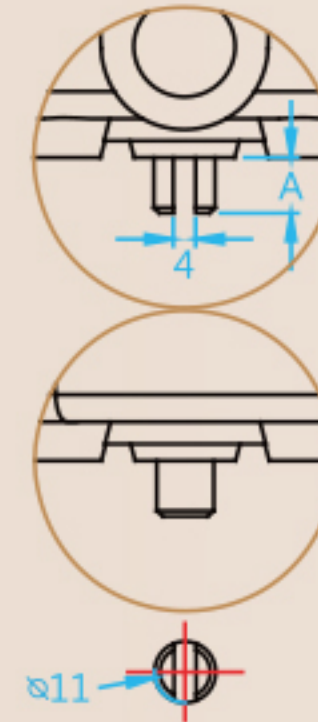

H7~H20- S

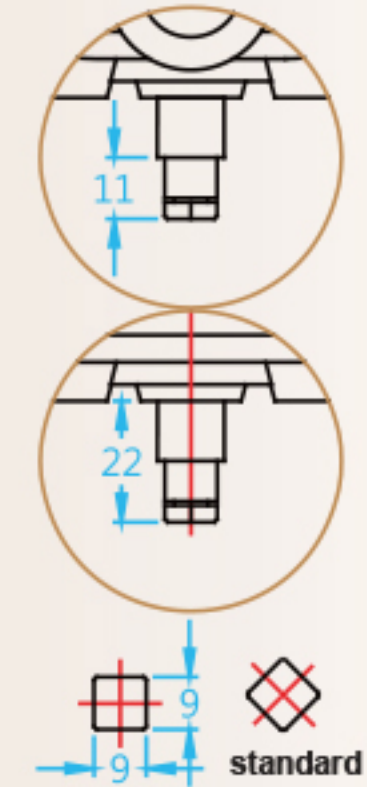

Mounting Flanged

Model	Q	Q1	Q2	W	W1	W2	A
H7~H20- S	42	60	/	M5	M6	/	/
H7~H20- B	42	60	/	M5	M6	/	/
H7~H20- N	/	/	40	/	/	M6	10
H7~H20- NH	/	/	40	/	/	M6	51.5

Model No.	H7-X-A22-15	H10-X-A22-30	H13-X-A22-45	H16-X-A22-50	H20-X-A22-90
Torque Rating (N-M)	7	10	13	16	20
Voltage supply 50/60Hz	AC220V ±10%	AC220V ±10%	AC220V ±10%	AC220V ±10%	AC220V ±10%
Control Signal	ON-OFF	ON-OFF	ON-OFF	ON-OFF	ON-OFF
Running Current	0.1A	0.1A	0.1A	0.1A	0.1A
Timing Nominal Driving 90° rotation to open close gate of valve	50Hz	16sec	31sec	46sec	91sec
	60Hz	15sec	30sec	45sec	90sec
Motor Power	5W	5W	5W	5W	5W
Performance Operation	Non consecutive running	Consecutive running	Consecutive running	Consecutive running	Consecutive running
Insulation level	E class				
Waterproof level	IP66				
Storage Temp. Range	-10°C to 50°C				
Operating Humidity Range	5 to 90% RH				
Electrical connection	1/2" cable connector				
Diameter of cable	1.25mm				
Optional Items	Auxiliary switches 2(SPDT) / Potentiometer 1KΩ				

AC110V, AC24V, and DC24V for choices

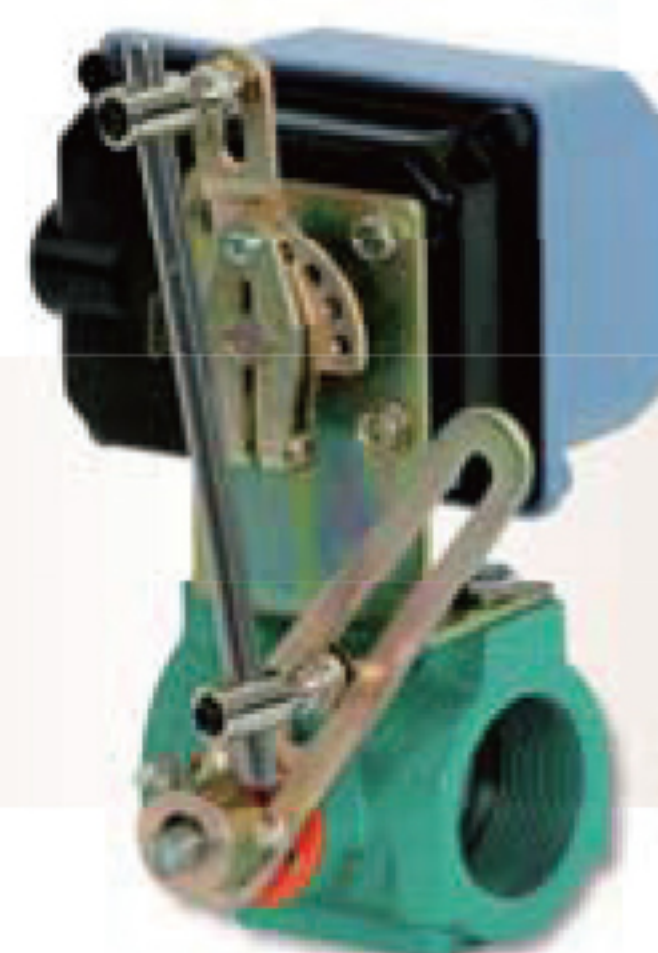
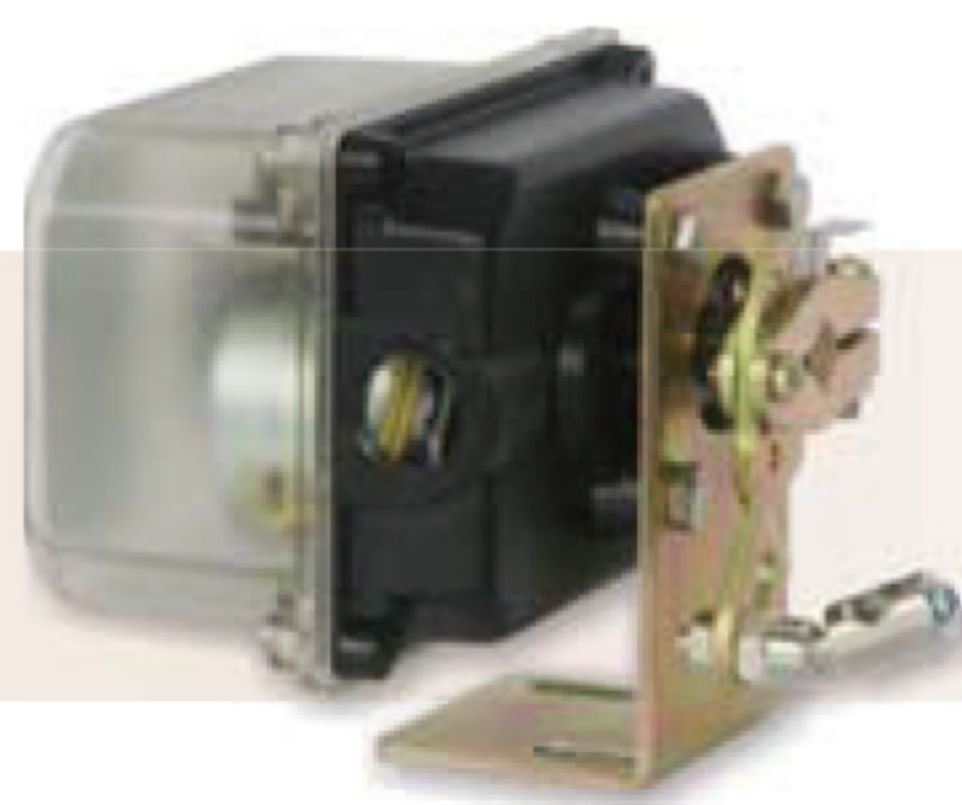

H15~H48

series

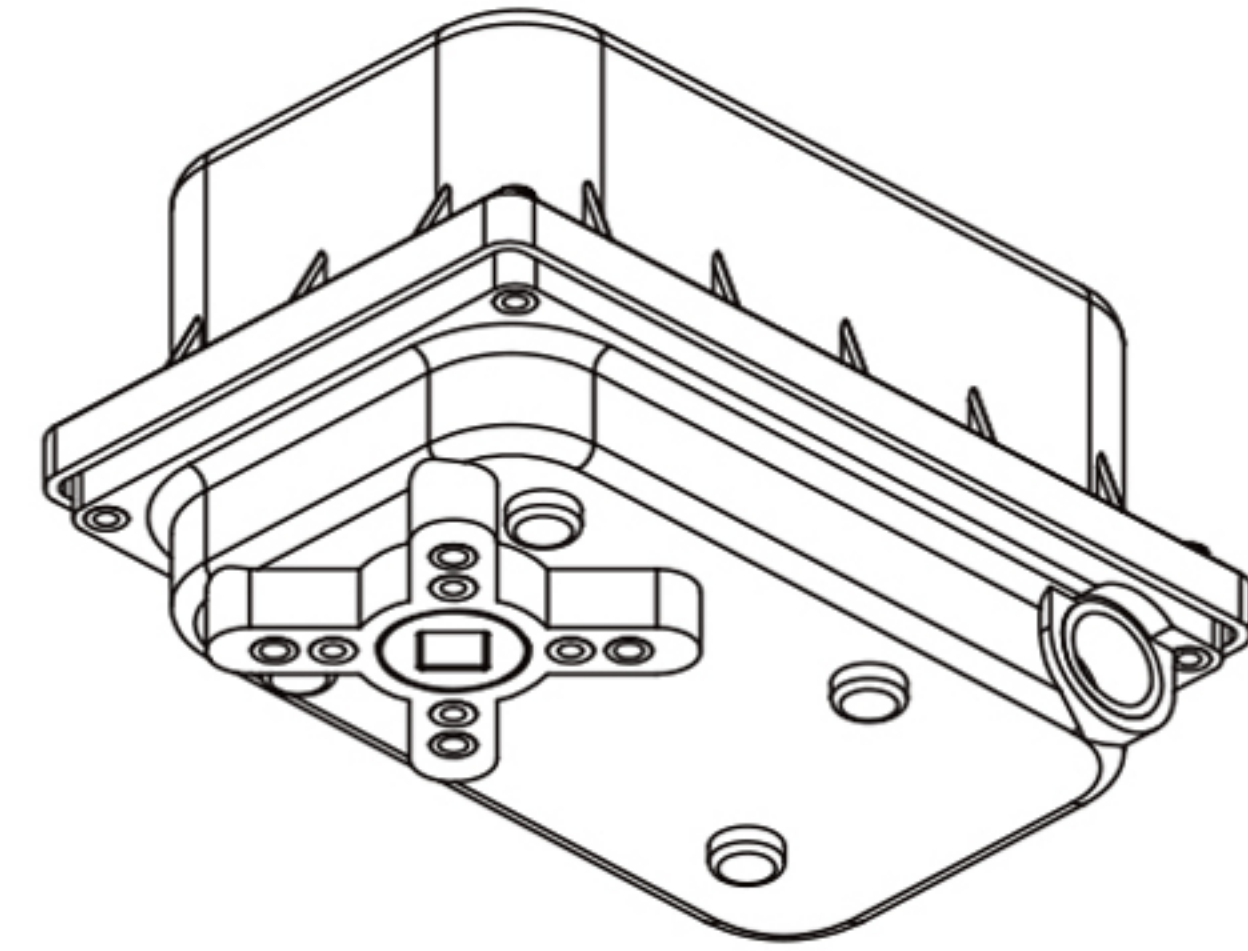
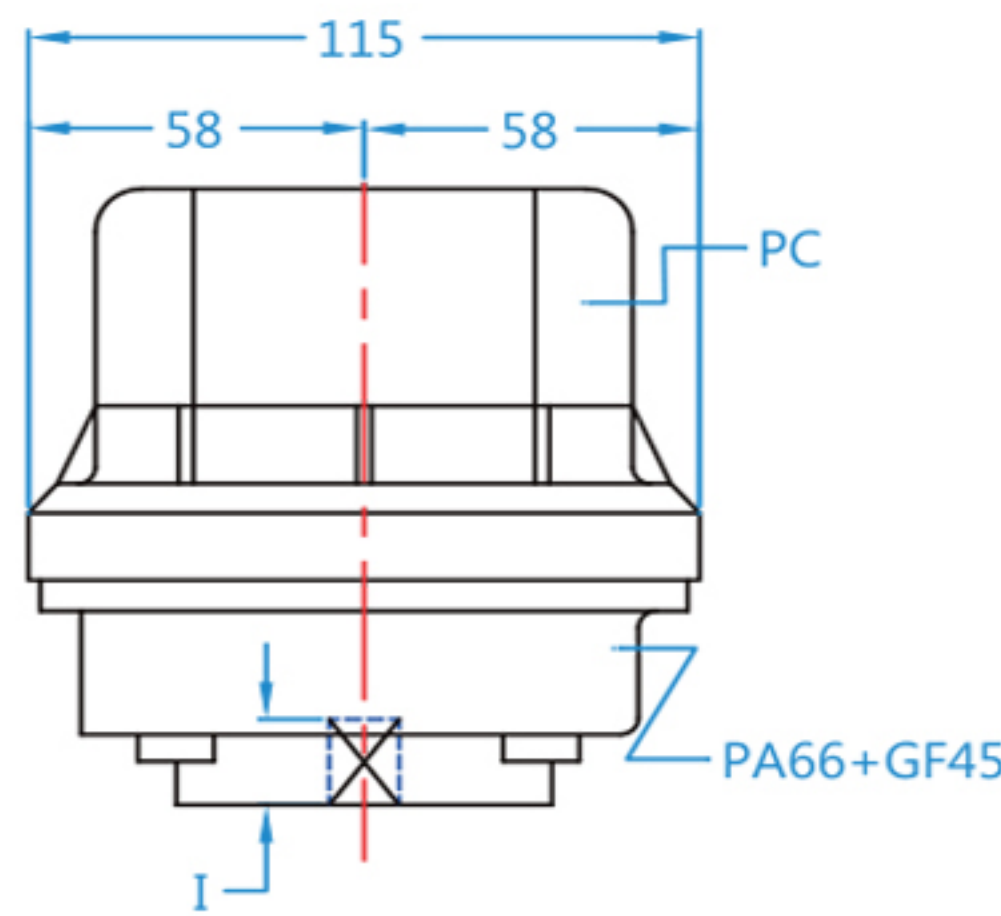
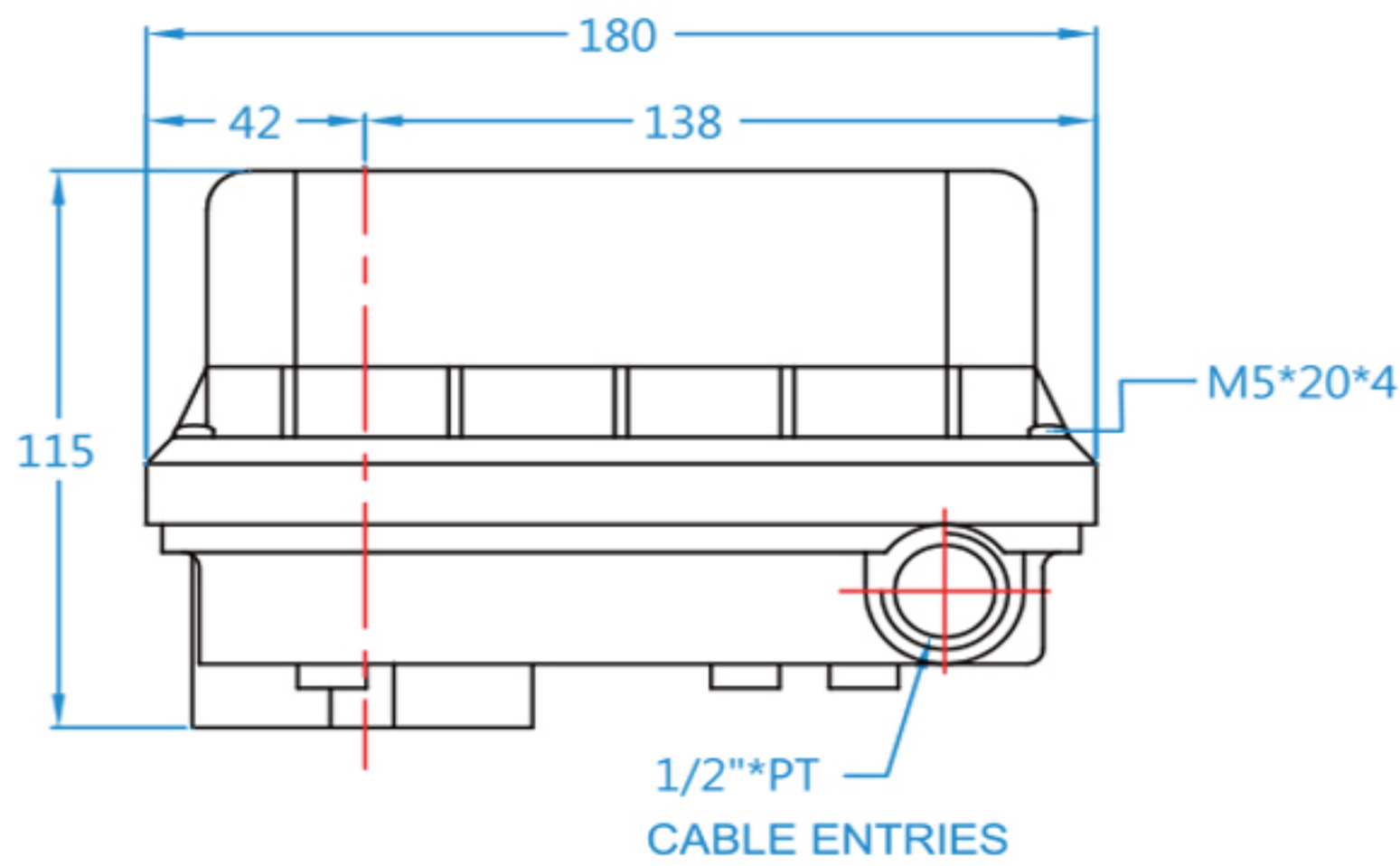
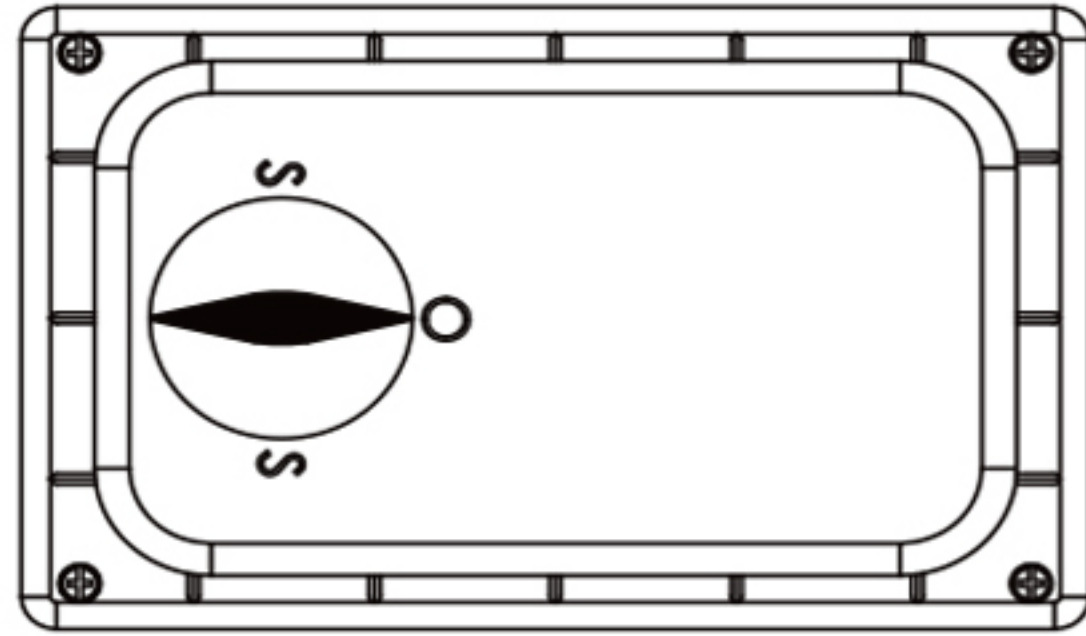

Unit [mm]

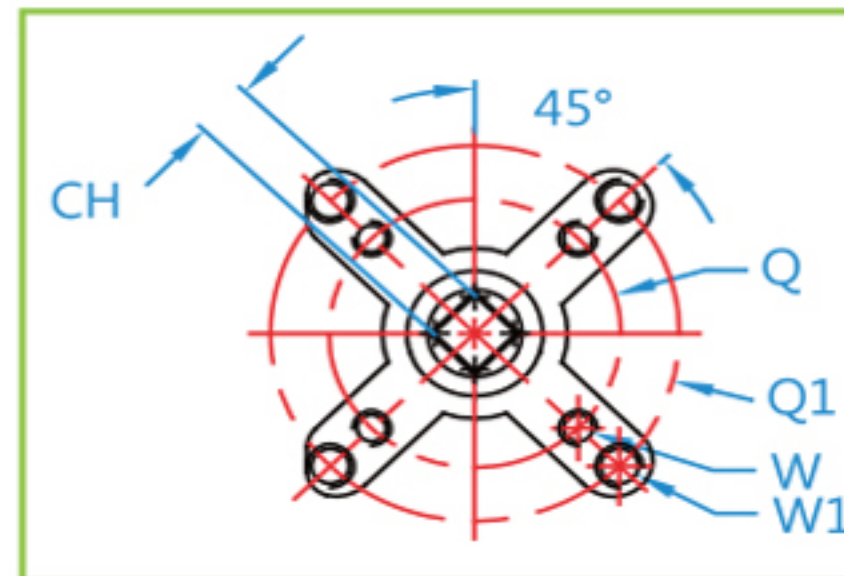

Model	Q	Q1	ISO Flange	W	W1	CH	I	N.W.
H15	∅42	∅60	F04	M5	M6	9	14	1.7kg
H23								
H18								
H35	∅50	∅70	F05/F07	M6	M8	9.11	14	1.7kg
H45								

Model	H15A2207	H23A2230	H18A2207	H35A2230	H48A2230	MH20A2230	MH32A2230
Torque Rating (Nm)	15	23	18	35	48	20	32
Supply Voltage 50/60Hz	AC220V ±10%	AC220V ±10%	AC220V ±10%	AC220V ±10%	AC220V ±10%	AC220V ±10%	AC220V ±10%
Control Signal	ON-OFF	ON-OFF	ON-OFF	ON-OFF	ON-OFF	0/4~20mA , 1/2~10mA , 0/2-10Vdc	
Max Inrush Current (A)	0.3	0.2	0.3	0.2	0.4	0.2	0.2
Running Current (A)	0.2	0.15	0.2	0.15	0.3	0.15	0.15
Timing Nominal Driving (50 Hz)	8sec	36sec	8sec	36sec	36sec	36sec	36sec
Timing Nominal Driving (60 Hz)	7sec	30sec	7sec	30sec	30sec	30sec	30sec
Moto Power (W)	25	10	25	10	25	10	10
Duty cycle	60%	S1	60%	S1	60%	S1	S1
Duty cycle(Remark)	S1: Continuous duty. 60%:O-15min-CO-10min-CO (Non Continuous duty).						
Motor protection	E class insulation						
Enclosure protection	IP66						
Storage Temperature Range	-10°C to 50°C						
Operating Humidity Range	90%RH Max. (non-condensing)						
Electrical Connection	1/2" PT cable connector, screw terminals						
Cable	1.25mm						
Optional Items	Auxiliary switches 2 (SPDT) / Potentiometer 1KΩ / Heater					4~20mA Feedback	
Net Weight ±0.3(kg)	1.8	1.8	1.8	1.8	1.8	2	2



H45~H115

series

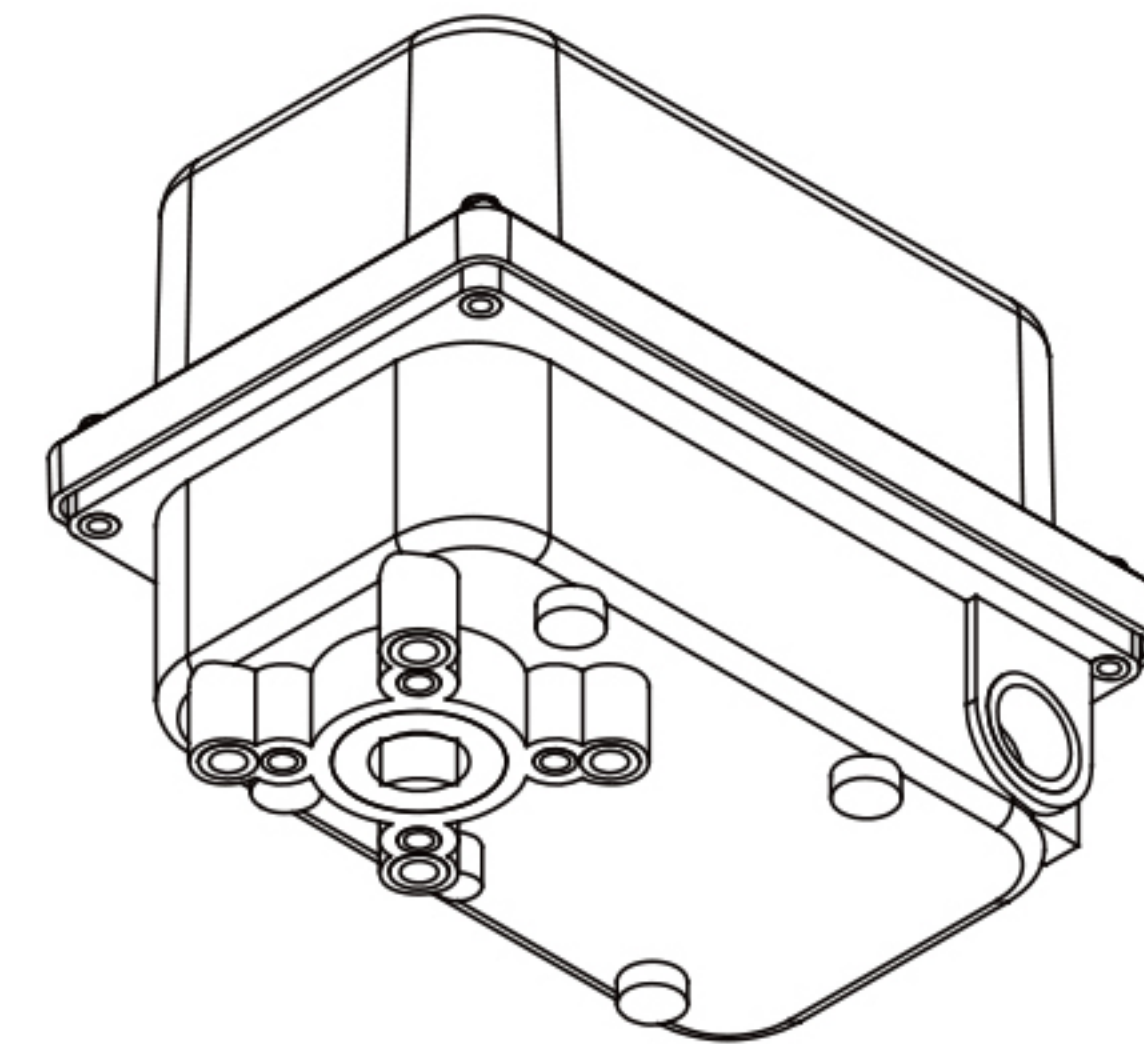
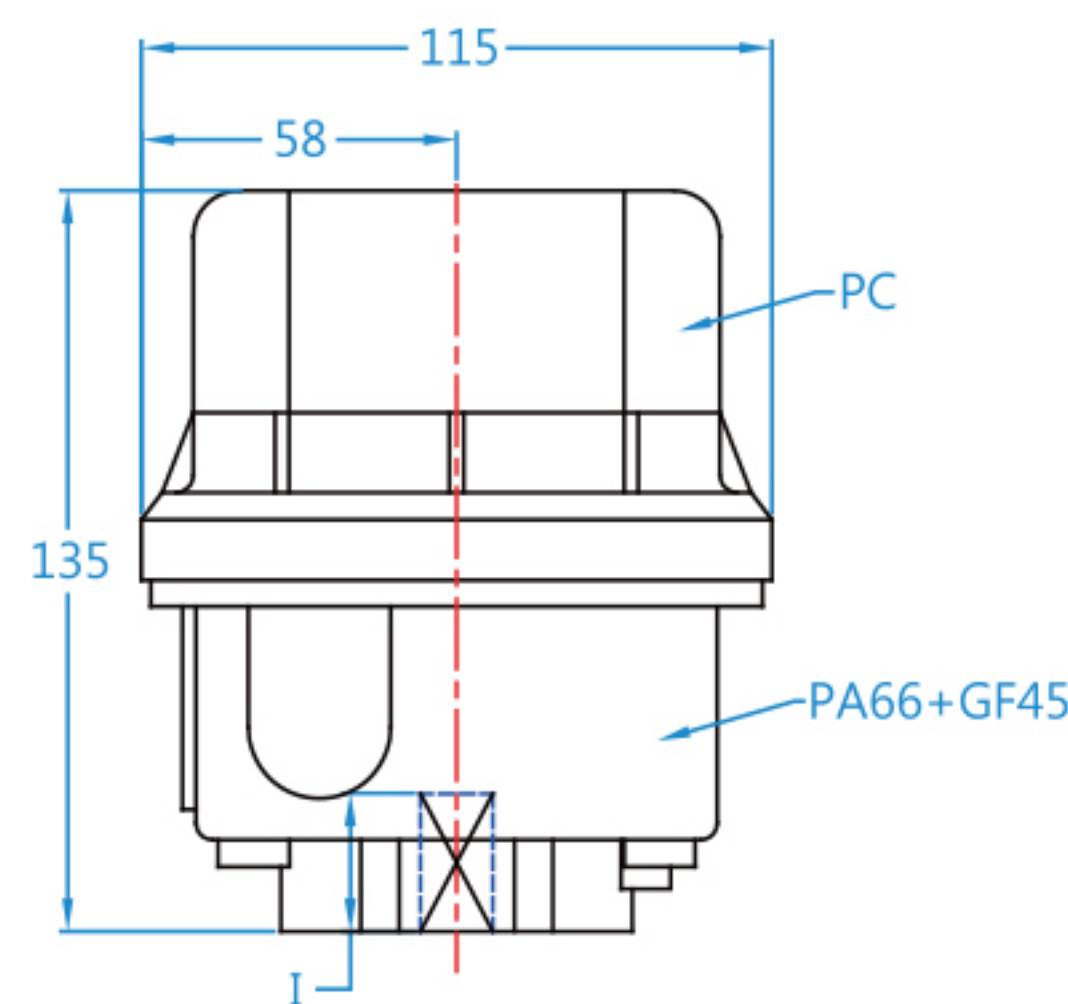
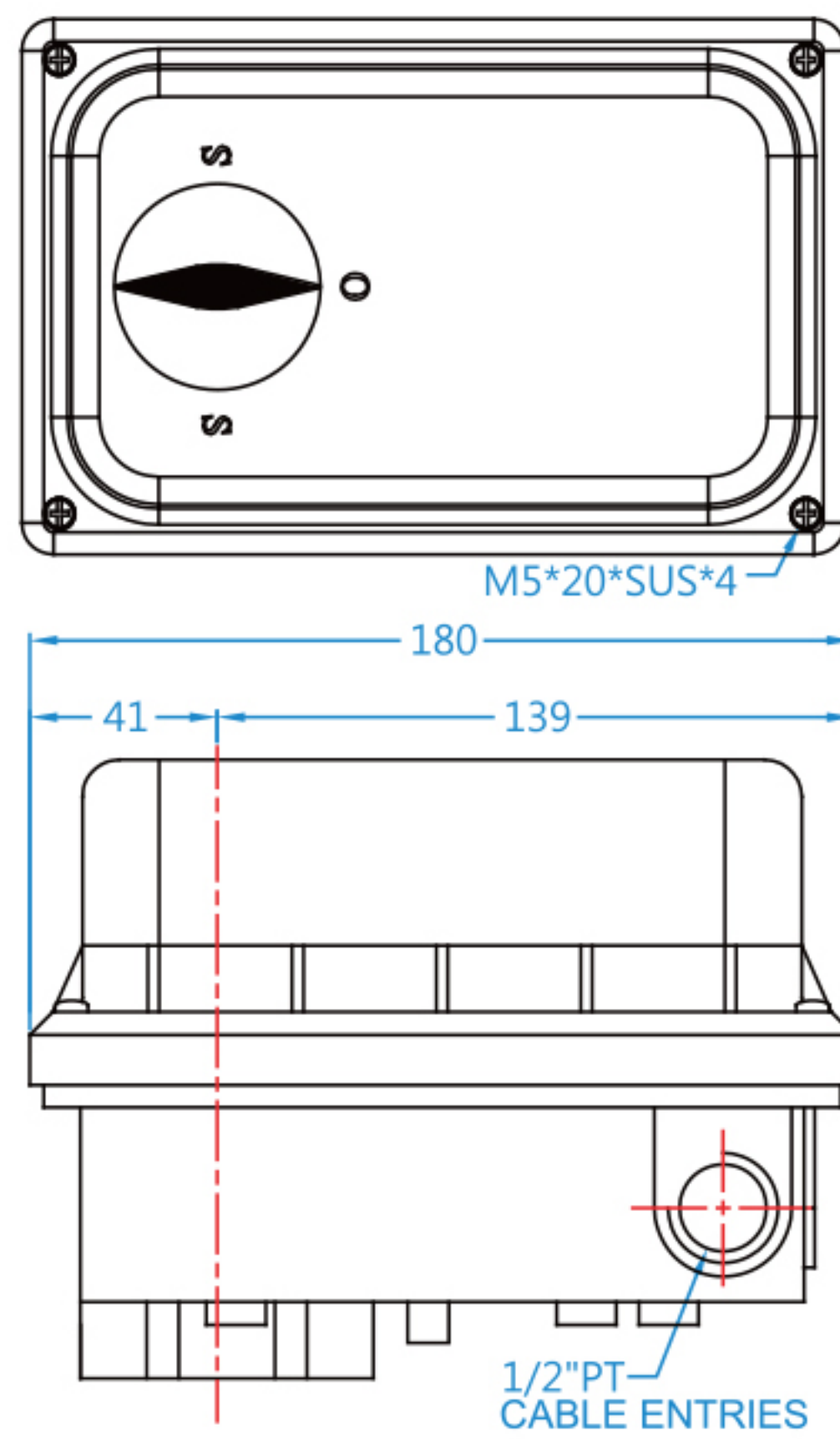

Unit [mm]

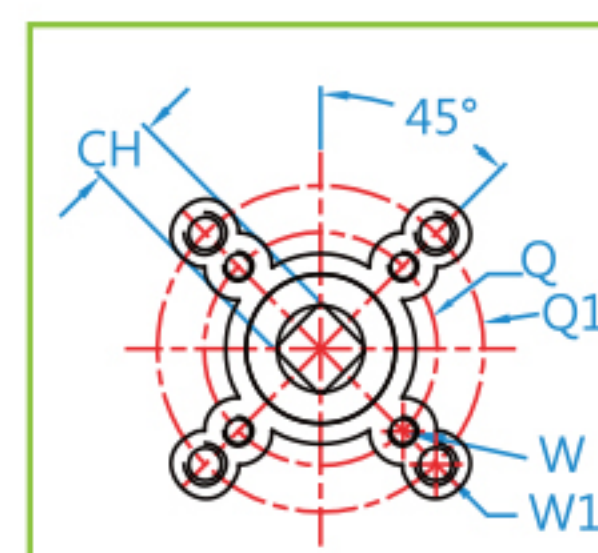

Model	Q	Q1	ISO Flange	W	W1	CH	I	N.W.
H45								
H70	ø50	ø70	F05 / F07	M6	M8	11.14 .17	25	2.7kg
H115								

Model	H45A2250	H70A2207	H70A2275	H115A2215	MH42A2250	MH67A2275
Torque Rating (Nm)	45	70	70	115	42	67
Supply Voltage 50/60Hz	AC220V ±10%	AC220V ±10%	AC220V ±10%	AC220V ±10%	AC220V ±10%	AC220V ±10%
Control Signal	ON-OFF	ON-OFF	ON-OFF	ON-OFF	0/4~20mA , 1/2~10mA , 0/2-10Vdc	
Max Inrush Current (A)	0.3	0.5	0.3	0.5	0.3	0.3
Running Current (A)	0.2	0.3	0.2	0.3	0.2	0.2
Timing Nominal Driving (50 Hz)	60sec	8sec	95sec	16sec	60sec	95sec
Timing Nominal Driving (60 Hz)	50sec	7sec	75sec	15sec	50sec	75sec
Moto Power (W)	10	35	10	35	10	10
Duty cycle	S1	60%	S1	60%	S1	S1
Duty cycle(Remark)	S1: Continuous duty. 60%:O-15min-CO-10min-CO (Non Continuous duty).					
Motor protection	E class insulation					
Enclosure protection	IP66					
Storage Temperature Range	-10°C to 50°C					
Operating Humidity Range	90%RH Max. (non-condensing)					
Electrical Connection	1/2" PT cable connector, screw terminals					
Cable	1.25mm					
Optional Items	Auxiliary switches 2 (SPDT) / Potentiometer 1KΩ / Heater				4~20mA Feedback	
Net Weight ±0.3(kg)	2.7	3	2.7	3.2	3	3